

Adattatore RSD-Ms-Ex (metrico, PG)

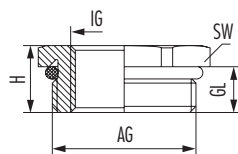

Materiale	Ottone nichelato
Materiale o-ring	NBR
Protezione	IP 68 – 10 bar / IP 69 K
Livello protezione ATEX	II 2G Ex eb IIC Gb / II 1D Ex ta IIIC Da
Temperatura di impiego	da -20°C a +95°C

RoHS

AG	IG	GL mm	H mm	SW mm	Art.
M16 x 1,5	M12 x 1,5	5	8	17	1.078.1612.50
M20 x 1,5	M12 x 1,5	6	9	22	1.078.2012.50
M20 x 1,5	M16 x 1,5	6	9	22	1.078.2016.50
M25 x 1,5	M16 x 1,5	7	10	29	1.078.2516.50
M25 x 1,5	M20 x 1,5	7	10	29	1.078.2520.50
M32 x 1,5	M16 x 1,5	8	11	34	1.078.3216.50
M32 x 1,5	M20 x 1,5	8	11	34	1.078.3220.50
M32 x 1,5	M25 x 1,5	8	11	34	1.078.3225.50
M40 x 1,5	M20 x 1,5	8	12	43	1.078.4020.50
M40 x 1,5	M25 x 1,5	8	12	43	1.078.4025.50
M40 x 1,5	M32 x 1,5	8	12	43	1.078.4032.50
M50 x 1,5	M25 x 1,5	9	13	55	1.078.5025.50
M50 x 1,5	M32 x 1,5	9	13	55	1.078.5032.50
M50 x 1,5	M40 x 1,5	9	13	55	1.078.5040.50
M63 x 1,5	M32 x 1,5	10	14	65	1.078.6332.50
M63 x 1,5	M40 x 1,5	10	14	65	1.078.6340.50
M63 x 1,5	M50 x 1,5	10	14	65	1.078.6350.50
PG 9	PG 7	6	8,8	17	1.078.0907.01
PG 11	PG 7	6	9	20	1.078.1107.01
PG 11	PG 9	6	9	20	1.078.1109.01
PG 13,5	PG 9	6,5	9,5	22	1.078.1309.01
PG 16	PG 9	6,5	9,5	24	1.078.1609.01
PG 16	PG 11	6,5	9,5	24	1.078.1611.01
PG 16	PG 13,5	6,5	9,5	24	1.078.1613.01
PG 21	PG 11	7	10,3	30	1.078.2111.01
PG 21	PG 13,5	7	10,3	30	1.078.2113.01
PG 21	PG 16	7	10,3	30	1.078.2116.01
PG 29	PG 16	8	11,5	40	1.078.2916.01
PG 29	PG 21	8	11,5	40	1.078.2921.01
PG 36	PG 21	9	12,5	50	1.078.3621.01
PG 36	PG 29	9	12,5	50	1.078.3629.01
PG 42	PG 29	10	13,5	57	1.078.4229.01
PG 42	PG 36	10	13,5	57	1.078.4236.01
PG 48	PG 36	10	13,5	64	1.078.4836.01
PG 48	PG 42	10	13,5	64	1.078.4842.01



alle istruzioni di
montaggio

